

ALLDAY
& MILLER



Cleave Avenue, Hayes, UB3 4HB
£415,000

3 1 1 F



Cleave Avenue, Hayes, UB3 4HB

£415,000

- Three Bedrooms
- Conservatory To The Rear
- Quiet Cul-De-Sac
- Great Condition Family Home
- Freehold
- Chain Free
- Gated Access to Garage
- Sought After Location
- Potential To Convert Loft (STPP)
- Only 0.6 Miles From Hayes And Harlington Station Crossrail

Description

An outstanding and deceptively spacious three bedroom terrace home found in a great location that's brought to the market in fantastic order making it perfect for first time buyers. This delightful home briefly consists of entrance porch, a 19ft living room that offers access through to the 12ft fitted kitchen. To the rear of the property there is a conservatory which is a perfect addition to the living space. To the first floor are the two well proportioned bedrooms with a slightly smaller third bedroom. Completing the first floor there is a bathroom suite. The property offers a front and rear garden. The rear garden has a hard-standing area closest to the house, the rest of the garden being mostly laid to lawn with a path leading to a rear gate for access and there are a variety of tree/shrubs and a storage shed. This property has the potential for a loft extension (STPP). There is also a garage via a secure gated entrance.

Situation

Cleave Avenue is a popular and well placed cul-de-sac that offers great access into Hayes town centre with its range of shops, eateries and restaurants. Hayes & Harlington train station can also be found within easy reach as can a multitude of bus routes. Heathrow Airport & the M4 motorway are also just a short drive away. From Hayes and Harlington train station drive down Station Road heading away from Hayes town centre and proceed over the junction with North Hyde Road and take the left hand turn into Station Road and follow the road down and take the fourth turning on the left into Cleave Avenue.



Floor Plans

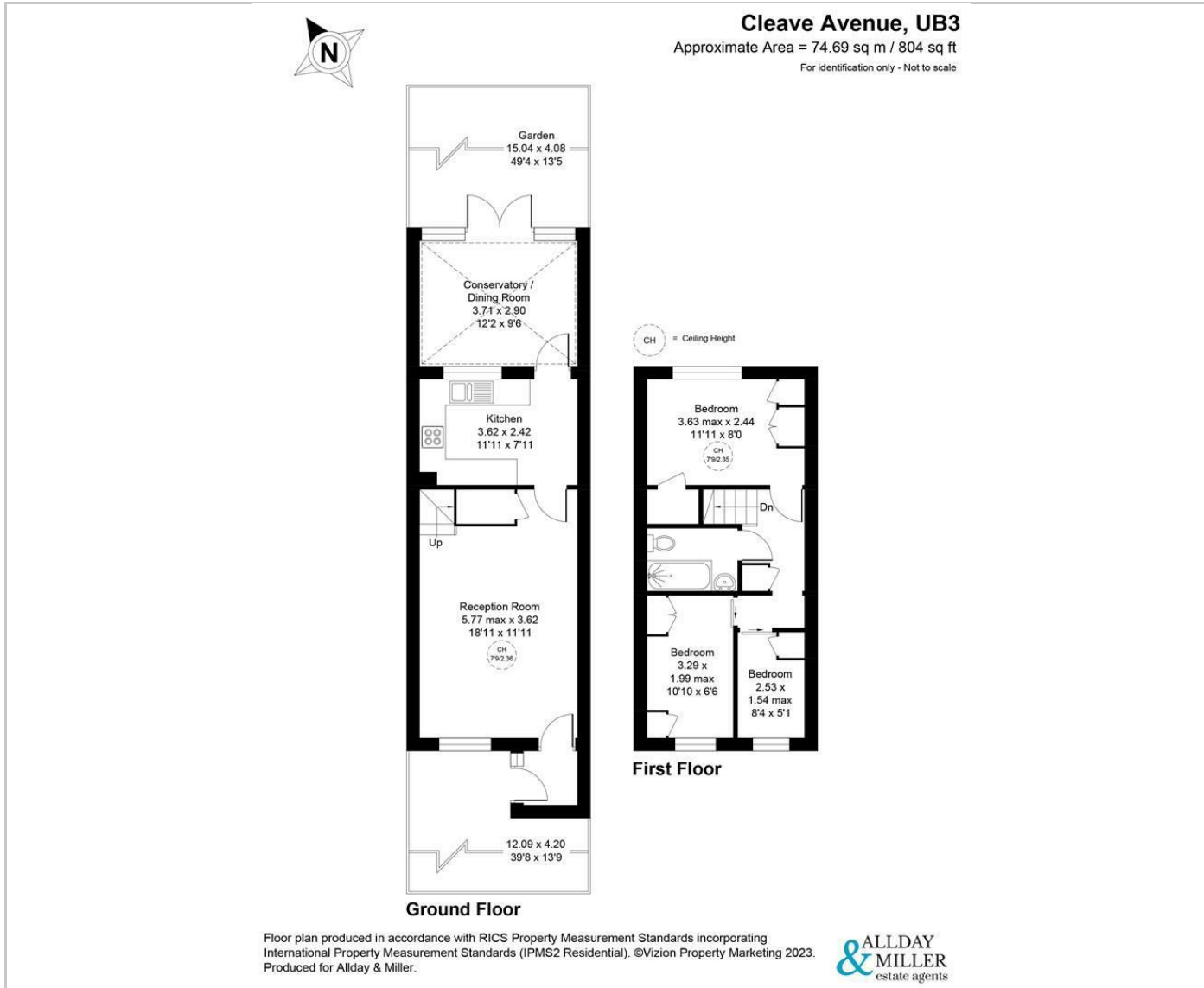

Area Map

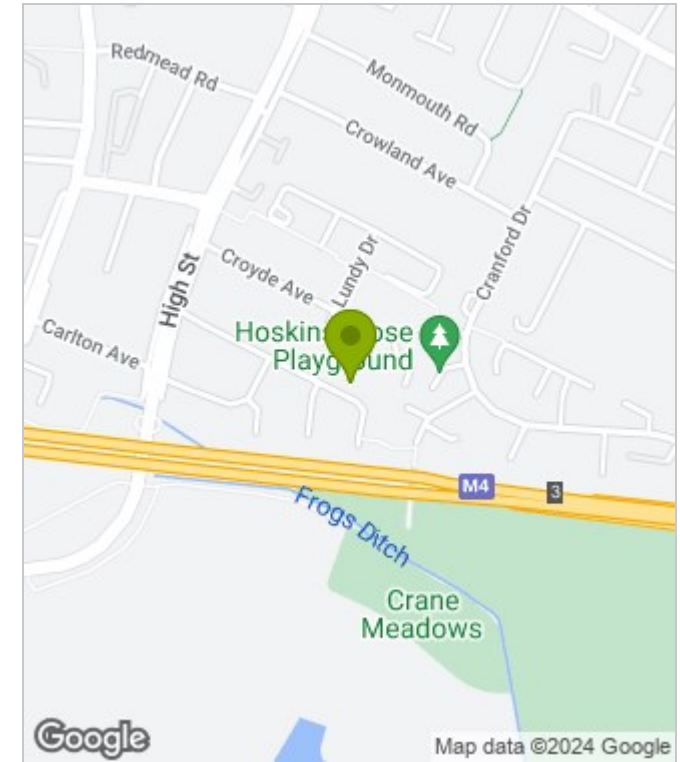

Energy Performance Graph

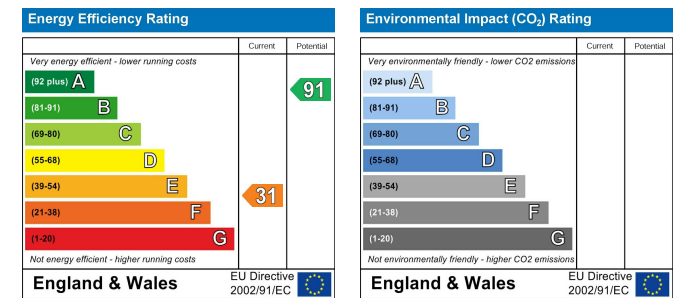

These particulars, whilst believed to be accurate are set out as a general outline only for guidance and do not constitute any part of an offer or contract. Intending purchasers should not rely on them as statements of representation of fact, but must satisfy themselves by inspection or otherwise as to their accuracy. No person in this firm's employment has the authority to make or give any representation or warranty in respect of the property.